

CMAH

CHELSEA MUSIC HALL

# ABOUT

CHELSEA MUSIC HALL IS RE-DEFINING **THE MUSIC HALL**

PAYING HOMAGE TO THE REVELRY AND RICH ENTERTAINMENT CULTURE OF CHELSEA'S PAST, CHELSEA MUSIC HALL WILL SHOWCASE A DIVERSE MIX OF PERFORMANCES RANGING FROM EMERGING ACTS TO ESTABLISHED ARTISTS THAT ARE ATTRACTED TO THE INTIMACY OF THE ROOM AS WELL AS THE QUALITY SOUND SYSTEM, LIGHTS AND SETTING. PERFORMANCES WILL INCLUDE ALL TYPES OF LIVE MUSIC, DJs, COMEDY, ART AND THEATRE AND GUESTS ARE ENCOURAGED TO POP IN ANY NIGHT TO DISCOVER A PIECE OF NYC CULTURE.

THE VENUE IS ALSO AVAILABLE ANY WEEKDAY BEFORE 6PM FOR FILM SHOTS, MEETINGS, ETC. AND ANY DATE CAN BE MADE AVAILABLE WITH A SHOW BUYOUT OF CLEOPATRA.





# WHERE

UNDERGROUND BUT **ALL ARE WELCOME**



**BENEATH CHELSEA MARKET AT 407 WEST 15TH STREET BETWEEN NINTH & TENTH AVENUE**

**AUDIENCE:**

**7,500+ EMPLOYEES WORK AT CHELSEA MARKET ON A DAILY BASIS**

**APPROXIMATELY 30-50,000+ UNIQUE VISITORS WALK THROUGH CHELSEA MARKET DAILY**



# THE SPACE

THE **QUALITY** OF A BIGGER ROOM MATCHED WITH  
THE **INTIMACY** OF YOUR FAVORITE LOCAL CLUB

## OCCUPANCY:

244

## SEATING:

66 CHAIRS + 40 SWIVEL (NO BACK) STOOLS

3 BANQUET SEATS (SEATS 40+)

12 STAINLESS STEEL FOLDING TABLES (6-8 SEATERS)

\*\*ALL CHAIRS AND STOOLS MAY ALSO BE STRUCK FROM FLOOR

## FOOD & DRINK:

EXECUTIVE CHEF EYAL SHANI (MIZNON)

PASSED FOODS MENU / CATERING PACKAGES AVAILABLE.

CLASSIC COCKTAIL MENU WITH BAR SPONSORSHIP/BUYOUT PACKAGES  
AVAILABLE.

## SECURITY:

AVAILABLE UPON REQUEST









# AV & BACKLINE

## MODULAR STAGE:

(6) 4X8 SEGMENTS I.E (12X16)  
OPTIONAL (3) 4X4 SEGMENTS

## SOUND:

SOUNDCRAFT IMPACT SOUNDBOARD

VOID TRI MOTION SOUND SYSTEM WITH  
POWER SOFT AMPS

## LIGHTING:

MADRIX SYSTEM FOR LED BULB MATRIX  
(600 LED RGB LIGHTS)

CHAMSYS MQ40N SYSTEM FOR MOVING  
AND SPOTLIGHTS

6 WASHES

6 MOVING LIGHTS

6 SPOT LIGHTS

**\*\*SOUND & LIGHTING STAFFING AVAILABLE  
UPON REQUEST**

## BACKLINE:

PIONEER DJM 900NXS MIXER

CDJ 2000NXS (3)

TECHNICS SL-1200 (2)

4 JBL FLOOR MONITORS

BACKLINE CONTINUED...

LUDWIG BREAKBEATS: KICK, 2 TOMS, SNARE  
W/ HARDWARE (PLEASE PROVIDE YOUR OWN  
SNARE & CYMBALS)

KBRACKES GRIPS SMOOTH SURFACE DRUM  
KIT ANCHORS (2)  
HI HAT STAND  
CYMBAL STANDS (2)  
DRUM STICKS

KEYBOARD STAND AND BENCH

FENDER RUMBLE BASS SPEAKER  
FENDER RUMBLE 200W BASS AMP HEAD  
FENDER PRINCETON GUITAR REVERB AMP

MICROPHONES

AKG D112 MKII (1)

SHURE SM58 (4)

SHURE SM57 (3)

STEREO DI BOX (2)

MONO DI BOX (3)

PROLINE MS112 DESKTOP BOOM MIC  
STAND

ALL CABLES





# LAYOUT

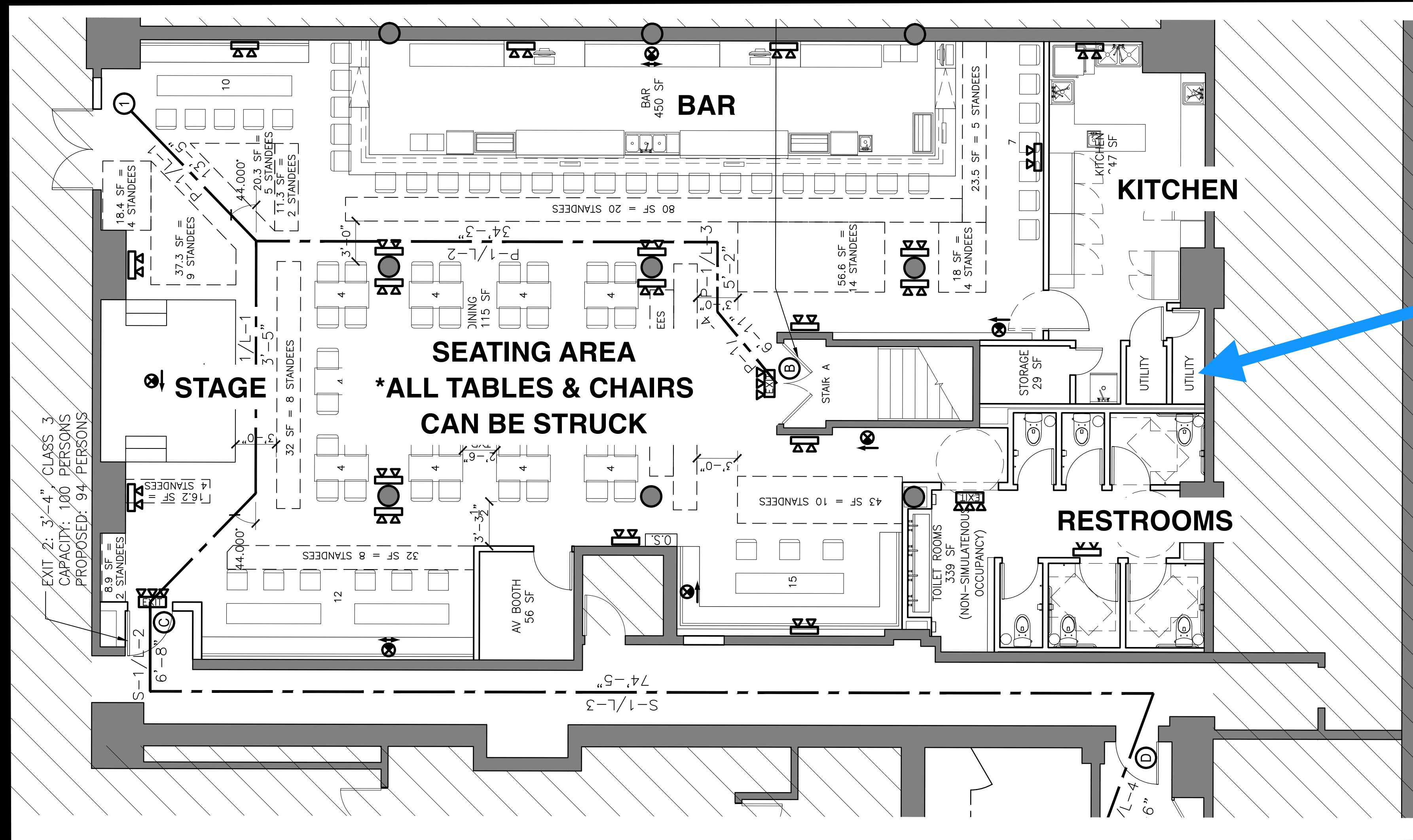

**ENTRANCE:  
407 W. 15TH  
BETWEEN 9TH  
& 10TH AVE**

# CONTACT

FOR CORPORATE OR PRIVATE EVENT INQUIRIES  
PLEASE SEND RELEVANT INFORMATION TO: [ABBIE@CHELSEAMUSICHALL.COM](mailto:ABBIE@CHELSEAMUSICHALL.COM)

FOR PRESS INQUIRIES ABOUT THE SPACE OR THE TEAM BEHIND IT,  
CONTACT [ASHLEY@WEARENIGHTAFTERNIGHT.COM](mailto:ASHLEY@WEARENIGHTAFTERNIGHT.COM)

FOR BOOKINGS,  
CONTACT [ELENI@CHELSEAMUSICHALL.COM](mailto:ELENI@CHELSEAMUSICHALL.COM)  
[MICHAEL@CHELSEAMARKET.COM](mailto:MICHAEL@CHELSEAMARKET.COM)



407 WEST 15TH STREET  
[CHELSEAMUSICHALL.COM](http://CHELSEAMUSICHALL.COM)  
[@CHELSEAMUSICHALL](https://www.instagram.com/CHELSEAMUSICHALL)



THANK  
YOU!

CHELSEA MUSIC HALL